

City of  
**Rolla**  
 Morton County, Kansas  
 Township 34 South - Range 40 West  
**ADDRESS MAP**

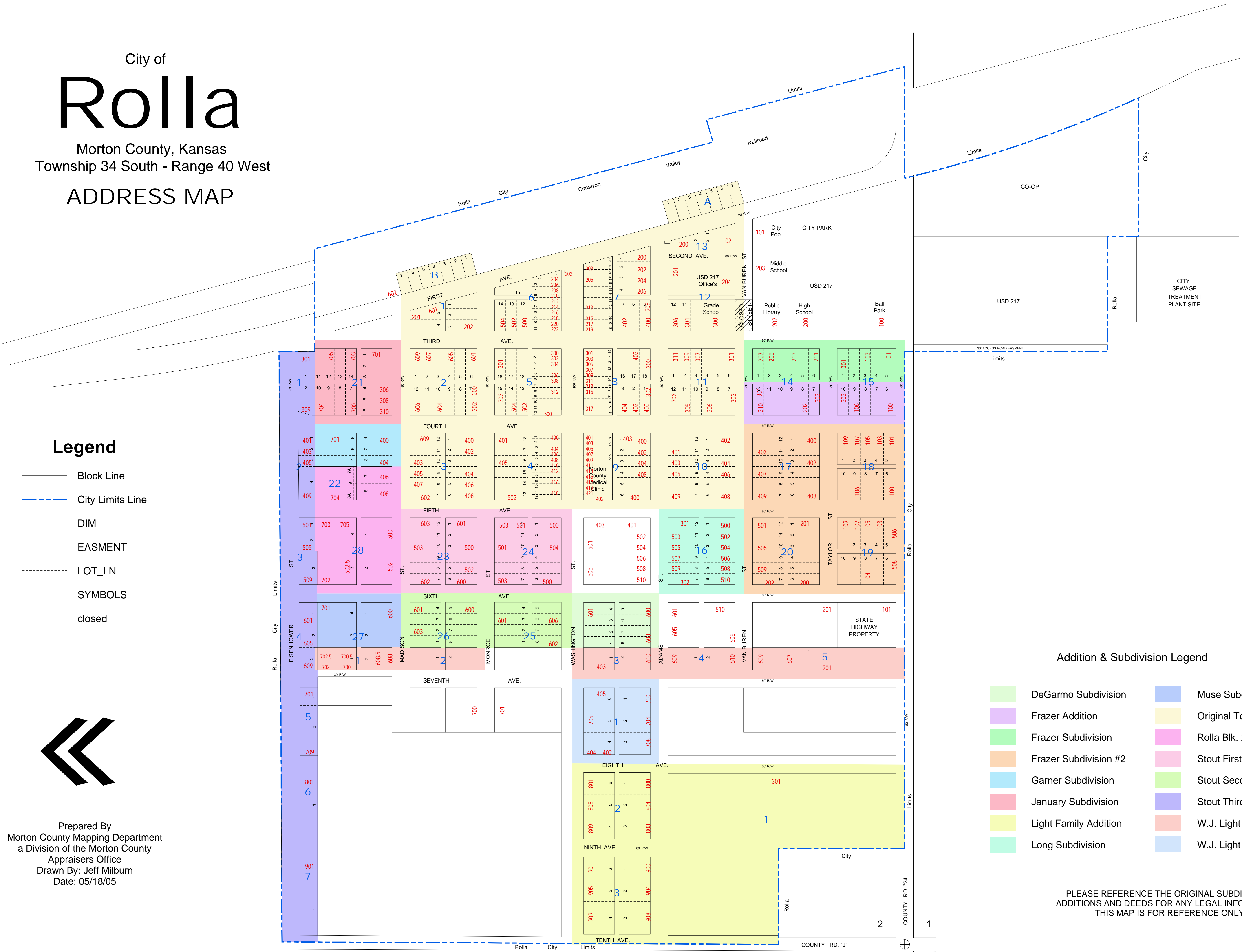

**Legend**

- Block Line
- City Limits Line
- DIM
- EASMENT
- LOT\_LN
- SYMBOLS
- closed

**Addition & Subdivision Legend**

- |                       |                           |
|-----------------------|---------------------------|
| DeGarmo Subdivision   | Muse Subdivision          |
| Frazer Addition       | Original Town             |
| Frazer Subdivision    | Rolla Blk. 22 & 28        |
| Frazer Subdivision #2 | Stout First Addition      |
| Garner Subdivision    | Stout Second Addition     |
| January Subdivision   | Stout Third Addition      |
| Light Family Addition | W.J. Light Addition       |
| Long Subdivision      | W.J. Light Third Addition |

PLEASE REFERENCE THE ORIGINAL SUBDIVISION, ADDITIONS AND DEEDS FOR ANY LEGAL INFORMATION. THIS MAP IS FOR REFERENCE ONLY.

Prepared By  
 Morton County Mapping Department  
 a Division of the Morton County  
 Appraisers Office  
 Drawn By: Jeff Milburn  
 Date: 05/18/05

